

SEZIONE D-D

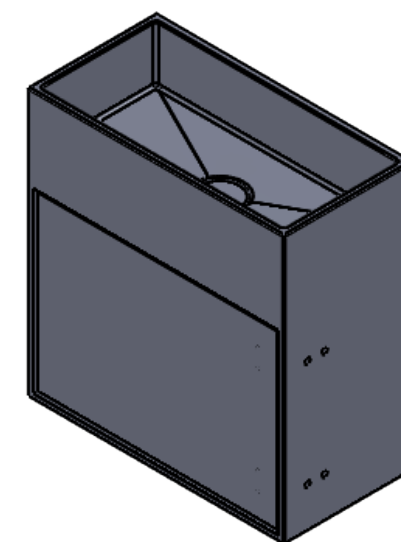
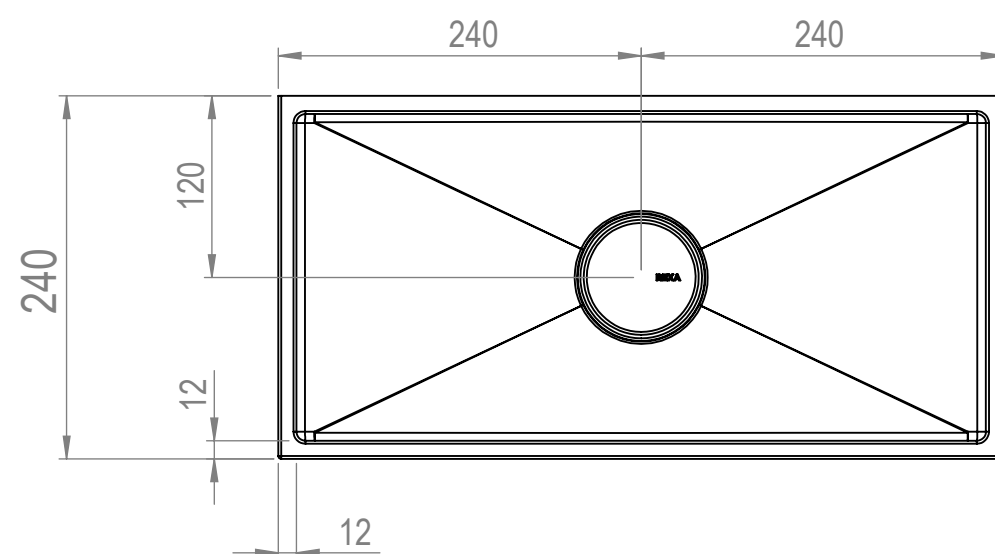

Lavabo compreso di piletta a scarico libero
Washbasin with plug
Washbecken mit Abfluss frei
Vasque à poser avec bonde à vidage fixe
Lavabo con desagüe libre
раковина в комплекте с донным клапаном

ANTA DX o SX
RIGHT or LEFT DOOR OPENING

REXA		Cod.Art.: MUNSA48C01	Descriz.: Lavamani con Ante
		Modello: UNICO	Descript.: Handbasin with Door
Autore: Uff.Tek. REXA	Data: 03-11-2023		Misure/Size: mm. L.480 P.240 H.500
Foglio: A3	Scala: 1:5	Tolleranza (L-P-H): Tolerance (W-D-H): +/- 2 mm	Finitura: Vedi Ordine
			Finish: See Order
Il presente disegno è di proprietà di REXA DESIGN. Si fa divieto a chiunque di riprodurlo o renderlo noto a terzi senza nostra autorizzazione scritta <i>This drawing is of REXA DESIGN properties. It is forbidden to reproduce or disclosed to third parties without our written authorization</i> Viste proiettate metodo Europeo Misure espresse in millimetri [Pollici] - Views projected European method Dimensions in mm [inch]			